

# APPLICATION FOR BUILDING PERMIT AND PLAN EXAMINATION

**CHECK FOR ANY DEED RESTRICTIONS**

**BLACKMAN CHARTER**

APPLICABLE TO THIS PROPERTY

**TOWNSHIP**

Use Group

AND/OR CONSTRUCTION.

1990 W. Parnall Rd.  
Jackson, Michigan 49201  
(517) 788-4345

Category

Cons Type

AUTHORITY: P.A. 230 of 1972, AS AMENDED  
COMPLETION: MANDATORY TO OBTAIN PERMIT  
PENALTY: PERMIT WILL NOT BE ISSUED

THE DEPARTMENT OF CONSUMER AND INDUSTRY SERVICES WILL NOT DISCRIMINATE AGAINST ANY INDIVIDUAL OR GROUP BECAUSE OF RACE, SEX, RELIGION, AGE, NATIONAL ORIGIN, COLOR, MARITAL STATUS, HANDICAP, OR POLITICAL BELIEFS.

## APPLICANT TO COMPLETE ALL SHADED ITEMS

**PARCEL NUMBER** 000-08-

### I. PROJECT INFORMATION

PROPERTY OWNER

ADDRESS

CITY

TOWNSHIP

**BLACKMAN**

COUNTY **JACKSON**

ZIP CODE 4920

### II IDENTIFICATION

#### A. OWNER OR LESSEE

NAME

ADDRESS

CITY

STATE

ZIP CODE

TELEPHONE

#### B. ARCHITECT / ENGINEER OR OWNER OF PROPERTY

NAME

ADDRESS

CITY

LICENSE NUMBER

STATE

ZIP CODE

TELEPHONE

#### C. CONTRACTOR

NAME

ADDRESS

CITY

STATE

ZIP CODE

TELEPHONE

BUILDERS LICENSE NUMBER

EXPERATION DATE

### EMAIL ADDRESS

### III. TYPE OF IMPROVEMENT AND PLAN REVIEW

#### A. TYPE OF IMPROVEMENT

NEW BUILDING

ADDITION

ALTERATION

REPAIR

WRECKING

MOBILE HOME SET-UP

FOUNDATION ONLY

PREMANU FACT

RELOCATION

#### B. REVIEW(S) TO BE PERFORMED

BUILDING

PLUMBING

MECHANICAL

REPLACE ROOF

REPLACE WINDOWS

ELECTRICAL

ENERGY

**IV. PROPOSED USE OF BUILDING**

**A. RESIDENTIAL - For "Demolition", show most recent use**

<input type="checkbox"/> ONE FAMILY	<input type="checkbox"/> TWO OR MORE FAMILY NO. OF UNITS _____	<input type="checkbox"/>	HOTEL, HOTEL NO. OF UNITS _____
<input type="checkbox"/> ATTACHED GARAGE	<input type="checkbox"/> DETACHED GARAGE	<input type="checkbox"/>	OTHER

**B. NON-RESIDENTIAL**

<input type="checkbox"/> AMUSEMENT	<input type="checkbox"/> CHURCH, RELIGION	<input type="checkbox"/>	INDUSTRIAL
<input type="checkbox"/> PARKING GARAGE	<input type="checkbox"/> SERVICE STATION	<input type="checkbox"/>	HOSPITAL, INSTITUTIONAL
<input type="checkbox"/> OFFICE, BANK, PROFES	<input type="checkbox"/> PUBLIC UTILITY	<input type="checkbox"/>	SCHOOL, LIBRARY, EDUCATIONAL
<input type="checkbox"/> STORE, MERCANTILE	<input type="checkbox"/> TANKS, TOWERS	<input type="checkbox"/>	OTHER

**GIVE DESCRIPTION OF WORK BEING DONE RESIDENTIAL OR NONRESIDENTIAL**

**ESTIMATED CONSTRUCTION COST: FOR COMMERICAL ADD., ALT.,REMODEL & SIGNS ONLY**

\$ \_\_\_\_\_

**V. SELECTED CHARACTERISTICS OF BUILDING**

**A. PRINCIPAL TYPE OF FRAME**

MASONRY, W  WOOD FRAME  STRUCTURAL STEEL  REINFORCED CONCRETE  OTHER

**B. PRINCIPAL TYPE OF HEATING FUEL**

GAS  OIL  ELECTRICITY  COAL  OTHER

**C. TYPE OF SEWAGE DISPOSAL**

PUBLIC OR PRIVATE COMPANY  SEPTIC SYSTEM

**D. TYPE OF WATER SUPPLY**

PUBLIC OR PRIVATE COMPANY  PRIVATE WELL OR CISTERN

**E. TYPE OF MECHANICAL**

WILL THERE BE AIR CONDITIONIN  YES  NO

**F. DIMENSIONS/DATA**

NUMBER OF STORIES _____	FLOOR AREA:	TOTAL LAND AREA _____ (SQUARE FEET)
	1ST & 2ND FLOOR _____	
	3RD - 10TH FLOOR _____	
	TOTAL AREA _____	

**G. NUMBER OF OFF STREET PARKING SPACES**

ENCLOSED \_\_\_\_\_ OUTDOORS \_\_\_\_\_

VI. APPLICANT INFORMATION

# WARNING NOTICE

**NO OCCUPANCY PERMITS WILL BE ISSUED OR PERSONS ALLOWED TO MOVE ON THE PREMISES UNTIL FINAL APPROVAL HAS BEEN RECEIVED FOR ALL BUILDING, MECHANICAL, PLUMBING, AND/OR ELECTRICAL WORK PERFORMED ON THE PREMISIS, IN ADDITION TO ZONING AND DEPT. OF PUBLIC WORKS APPROVAL.**

**APPLICANT IS RESPONSIBLE FOR THE PAYMENT OF ALL FEES AND CHARGES APPLICABLE TO THIS APPLICATION AND MUST PROVIDE THE FOLLOWING INFORMATION.**

I HEREBY CERTIFY THAT THE PROPOSED WORK IS AUTHORIZED BY THE OWNER OF RECORD AND THAT I HAVE BEEN AUTHORIZED BY THE OWNER TO MAKE THIS APPLICATION AS HIS/HER AUTHORIZED AGENT, AND WE AGREE TO CONFORM TO ALL APPLICABLE LAWS OF THE STATE OF MICHIGAN. ALL INFORMATION SUBMITTED ON THIS APPLICATION IS IS ACCURATE TO THE BEST OF MY KNOWLEDGE.

**Section 23a of the state construction code act of 1972, 1972 PA 230, MCL 125.1523A,** to circumvent the licensing requirements of this state relating to persons who are to perform work on a residential building or a residential structure. Violators of section 23a are subjected to civil fines.

**FEE ENCLOSED \$ \_\_\_\_\_ OR STATE ACCOUNT NO. \_\_\_\_\_**

**Signature of Applicant \_\_\_\_\_ Application Date \_\_\_\_\_**

**VII. LOCAL GOVERNMENTAL AGENCY TO COMPLETE THIS SECTION**

**ENVIRONMENTAL CONTROL APPROVALS**

	REQUIRED?	APPROVED	DATE	NUMBER	BY
A- ZONING/DISTRICT	YES NO				
1. SITE PLAN APPROVAL	YES NO				
2. VARIANCE GRANTED	YES NO				
B-FIRE	YES NO				
C-POLLUTION CONTROL	YES NO				
D- FLOOD ZONE	YES NO				
E- SOIL EROSION/COUNTY D	YES NO				
F- TWP. WATER/SEWER	YES NO				
G- WATER/COUNTY HEALTH	YES NO				
H- SEPTIC/COUNTY HEALTH	YES NO				
I- COUNTY ROAD COMM.	YES NO				
J- ASSESSING DEPT.	YES NO				

**COMPUTER PROPERTY TAX # \_\_\_\_\_**

**ALL PERSONAL AND PROPERTY \_\_\_\_\_ YES \_\_\_\_\_ NO \_\_\_\_\_**

**VIII. VALIDATION**

BUILDING PERMIT NUMBER	APPROVED BY	
ISSUE DATE	SIGNATURE	

# ILLUSTRATIONS OF ZONING TERMS GENERAL LOT TERMS

FILL IN ALL MEASUREMENTS BETWEEN PROPERTY LINES AND BUILDINGS

WRITE THE NUMBERS IN THE OPENINGS IN THE LINES

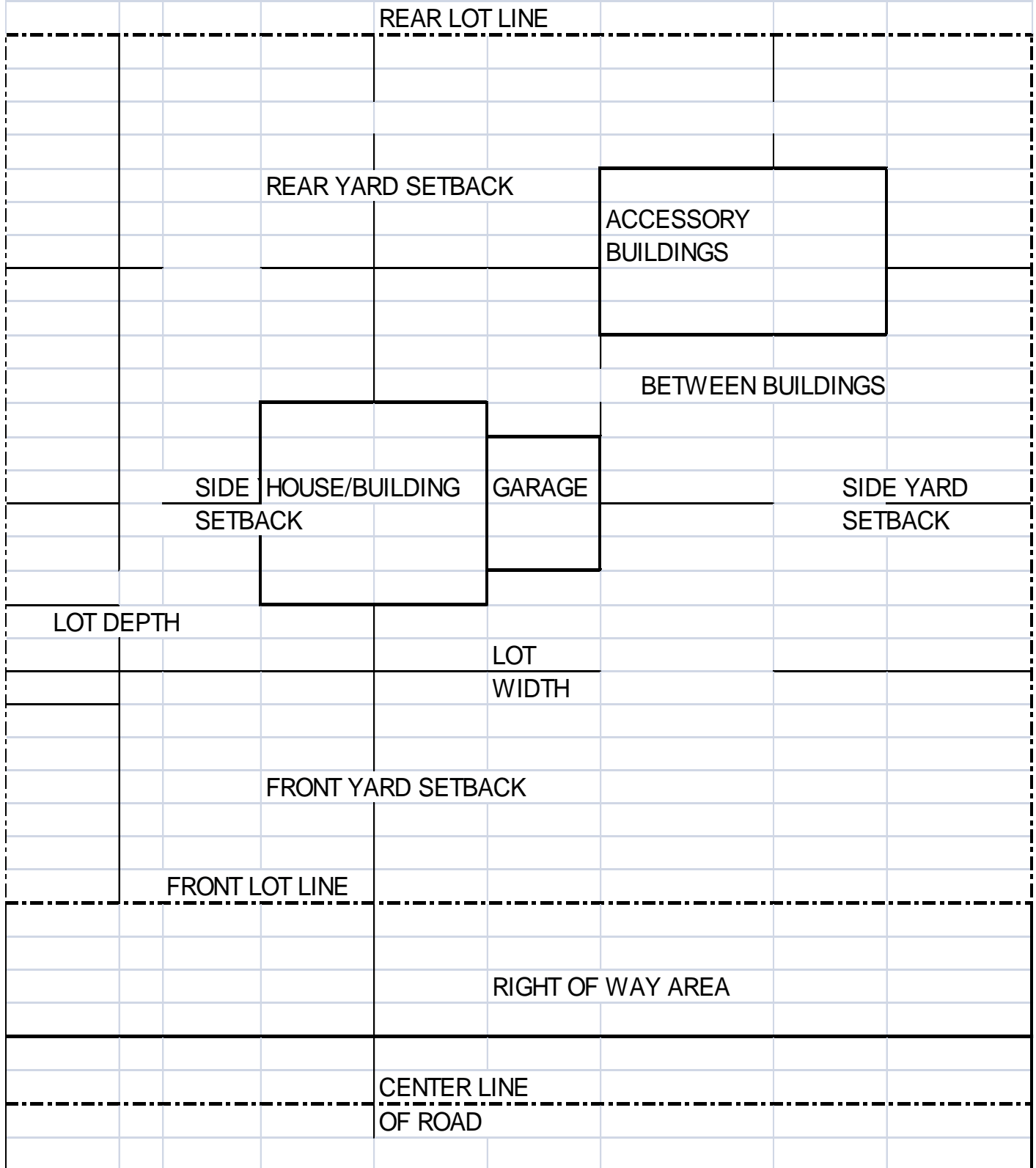

**BLACKMAN CHARTER TOWNSHIP BUILDING PERMIT FEES**  
 IN COMPUTING THE CONSTRUCTION COST AND BUILDING  
 PERMIT FEES, THE COMPUTATION SHALL BE AS FOLLOWS:

ADMINISTRATION FEE	\$25.00 ALL PERMITS SUBJECT TO FEE
<b>CONTRACTOR REGISTRATION FEE ALL CONTRACTORS</b>	\$15.00
One- & two-Family Res. Buildings	\$75.00 per sq. ft - \$3.50 per thousand
Residential Additions	\$75.00 per sq. ft - \$3.50 per thousand
Residential Remodel	\$55.00 per sq. ft - \$3.50 per thousand
Residential Garages, Breezeways, Carports, Pole Buildings	\$45.00 per sq. ft - \$3.50 per thousand
Multiple Family Dwellings	\$80.00 per sq. ft – \$4.50/M per Bldg. up to & including \$200.00 - \$3.50/M thereafter. Separate Permit for each Building
Mobile/Modular Homes – In Park	\$210.00 *Includes Plumbing & Mechanical Inspections (Electrical is not included)
Basement under Existing Building	\$150.00
All Swimming Pools	\$25.00 above ground \$100.00 in ground
Deck	\$150.00 2 inspections footing/final
SHEDS OVER 200 SQUARE FEET	\$50.00
Demolition	150.00
Zoning Fee (ALL BUILDING PERMITS)	\$40.00
VARIANCE \$350.00. ZONING CHANGE \$400.00. SITE CONDOS, PC-1 & PR-1 \$550.00	CONDITIONAL USE \$400.00. HOME OCCUPATION \$300.00. SITE PLAN REVIEW \$450.00 ADMIN. SITE PLAN REVIEW \$175.00
ALL COMMERCIAL& INDUSTRIAL BUILDING WILL BE COMPUTED BY THE BS&A SOFTWARE PER BUILDING TYPE AND SQ. FT:	1/10 <sup>th</sup> of 1% for Plan Review \$50.00 for 1 <sup>st</sup> Thousand or Fraction thereof \$4.00/M thereafter up to \$200,000.00; \$3.00/M thereafter
SIGN: TEMPORARY \$35.00 FOR 15 DAY IN A 90 DAY PERIOD	COMMERCIAL SIGNS ESTIMATED COST THEN CALCULATED AS ABOVE MINUS PLAN REVIEW
REPLACE SHINGLE TEAR OFF AND REPLACE	\$50.00
REPLACEMENT WINDOWS	\$50.00
<b>SOLAR:</b> GROUND MOUNTED SOLAR PANELS	\$150.00 (2 INSPECTIONS)
<b>SOLAR:</b> ROOF MOUNTED	\$50.00